

4'-0" x 4'-0" x 4'-6"
KNOCK OUT BOX

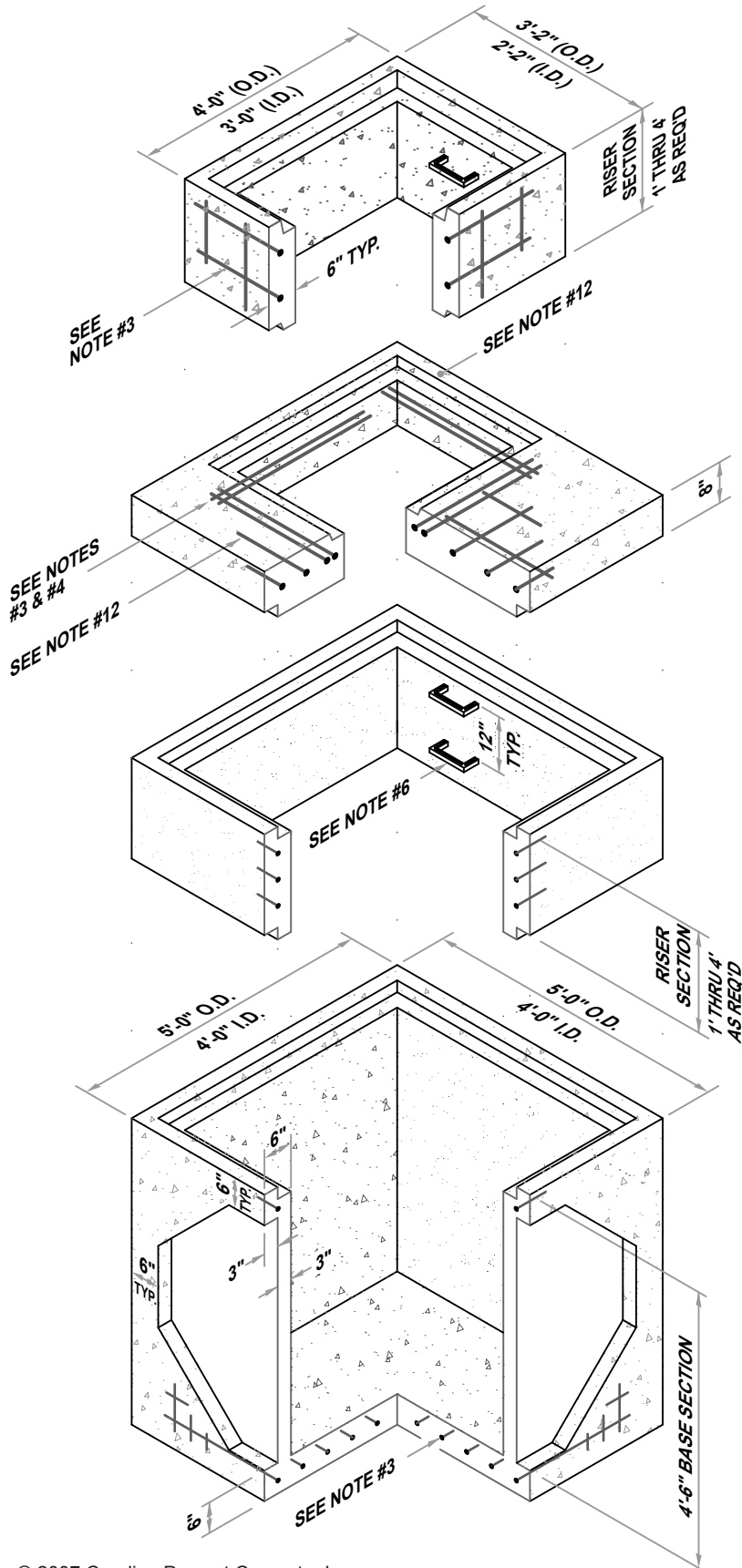

GENERAL NOTES:

1. CATCH BASIN SPECIFICATIONS CONFORM TO LATEST ASTM C-913 SPECS FOR "REINFORCED CONCRETE WATER AND WASTEWATER STRUCTURES" AND NCDOT STANDARDS.
2. CONCRETE COMPRESSIVE STRENGTH 4,000 PSI. MINIMUM
3. REINFORCING STEEL DESIGN TO BE SPECIFIED BY THE NCDOT AND BE CONSISTENT IN ALL THE REQUIREMENTS OF ACI 318 AND SHALL UTILIZE GRADE 60 REBARS CONFORMING TO THE REQUIREMENTS OF A615 OR WWF CONFORMING TO THE REQUIREMENTS OF ASTM A185 OR BOTH.
4. DESIGNED FOR HS-20-44 LOADING.
5. PIPE PENETRATION TO BE AS PER JOB REQUIREMENTS. PIPE TO BE INSTALLED BY CONTRACTOR AS PER NCDOT REQUIREMENTS FOR MORTAR JOINT CONNECTIONS.
6. STEPS REQUIRED ON CATCH BASINS OVER 3'-6" IN DEPTH. STEPS SHALL BE STEEL REINFORCED COPOLYMER POLYPROPYLENE PLASTIC AND MEET THE REQUIREMENTS OF ASTM C478.
- 6A. STEPS NOT TYPICALLY PROVIDED IN KNOCK-OUT BASE SECTION.
7. JOINTS TO BE SEALED WITH BUTYL RUBBER JOINT SEALANT CONFORMING TO THE REQUIREMENTS OF ASTM C990, OR MORTAR AS PER NCDOT REQUIREMENTS, OR BOTH.
8. TOTAL HEIGHT AS PER JOB REQUIREMENTS. CONTRACTOR TO ADJUST TO GRADE AS REQ'D.
9. DOT APPLICATION = 840.17 / 840.18 / 840.19 / 840.26 / 840.27 / 840.28 / 840.31 / 840.32
10. MAXIMUM PIPE SIZE ENTERING ANY WALL AT 90 DEGREES IS 36" RCP
11. BASE WEIGHT - 7,900 LBS.
12. REDUCER IS GROOVED TO ACCEPT 2'-2" x 3'-0" (I.D.) RISER SECTION.