

**DOT TRAFFIC SIGNAL CONTROLLER
CABINET PAD**

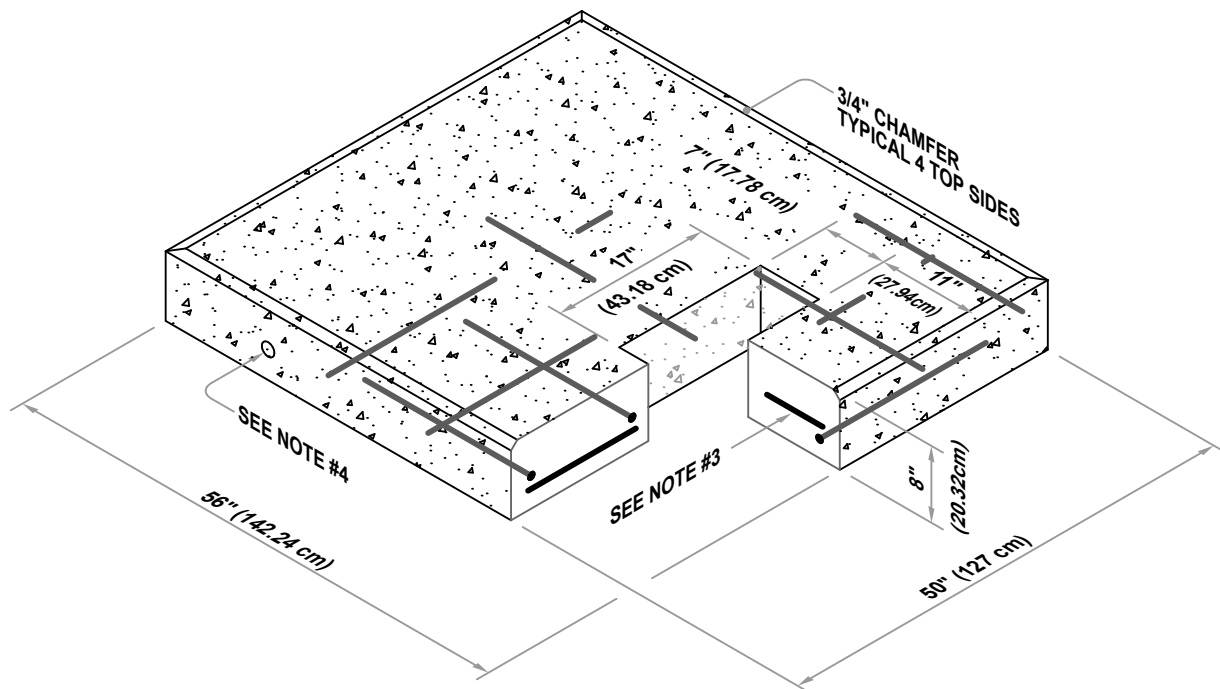

GENERAL NOTES:

1. DESIGN CONFORMS TO ASTM C858 FOR UNDERGROUND PRECAST CONCRETE UTILITY STRUCTURES AND IS LISTED AS AN NCDOT QUALIFIED PRODUCT.
2. CONCRETE COMPRESSIVE STRENGTH 5,000 PSI MINIMUM.
3. STEEL REINFORCING DESIGN TO CONFORM TO THE REQUIREMENTS OF ASTM C857 SPECIFICATIONS FOR "STRUCTURAL DESIGN LOADING FOR WATER AND WASTEWATER STRUCTURES" AND SHALL UTILIZE GRADE 60 RE-BARS CONFORMING TO THE REQUIREMENTS OF ASTM A615 OR WWF CONFORMING TO THE REQUIREMENTS OF ASTM A185 OR BOTH.
4. 3/4" COIL THREAD INSERTS FOR LIFTING (TYPICAL 4 PLACES).