

**4' DIAMETER PRECAST
EXTENDED BASE WET WELL**

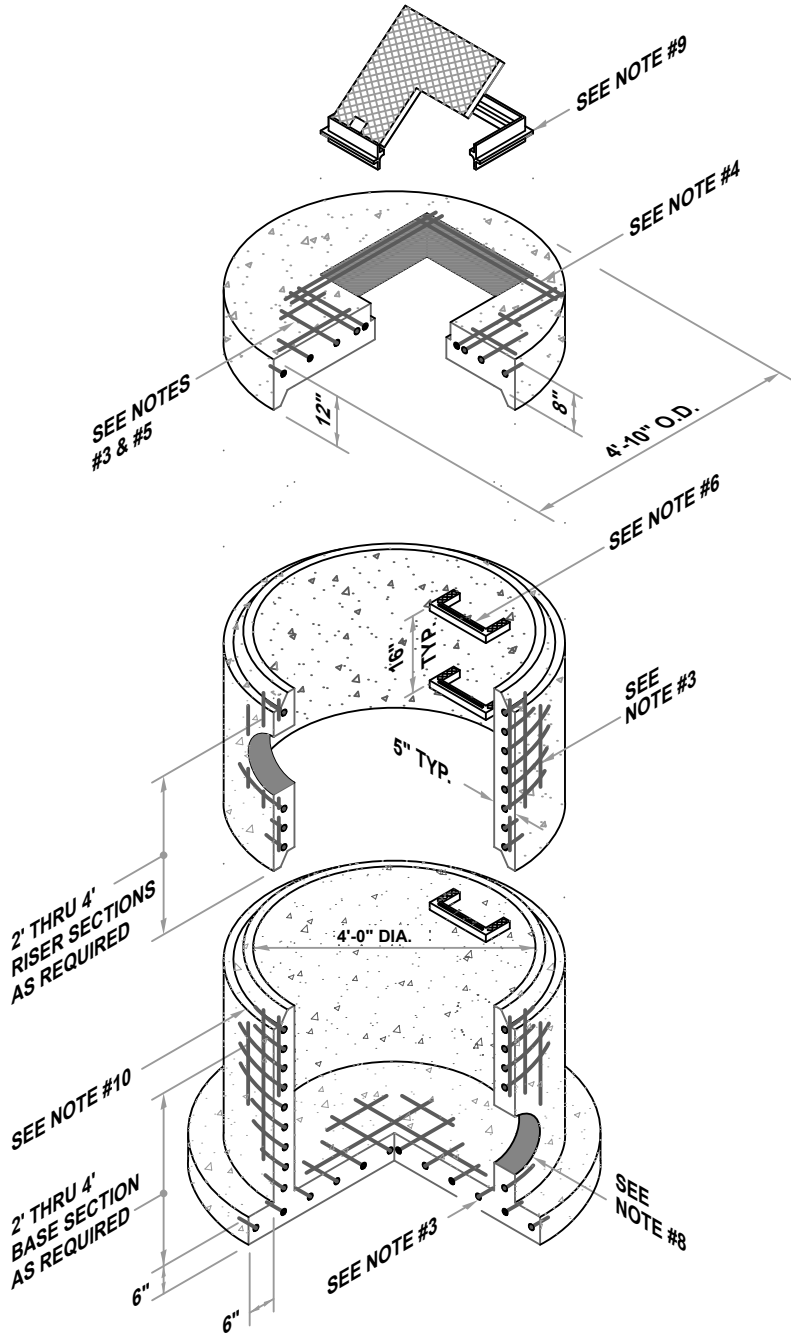

GENERAL NOTES:

1. MANHOLE DESIGN SPECIFICATIONS CONFORM TO LATEST ASTM C478 SPECIFICATIONS FOR "PRECAST REINFORCED CONCRETE MANHOLE SECTIONS" AND NCDOT.
2. CONCRETE COMPRESSIVE STRENGTH 4,000 PSI MIN.
3. STEEL REINFORCING DESIGNED TO CONFORM TO THE REQUIREMENTS OF ASTM C478 AND SHALL UTILIZE GRADE 60 RE-BARS CONFORMING TO THE REQUIREMENTS OF ASTM A615 OR WWF CONFORMING TO THE REQUIREMENTS OF ASTM A185 OR DRAWN WIRE CONFORMING TO THE REQUIREMENTS OF A82 OR A COMBINATION THEREOF.
4. ADDITIONAL REINFORCING AT OPENINGS.
5. DESIGNED FOR H-20 LOADING.
6. STEPS SHALL BE STEEL REINFORCED COPOLYMER POLYPROPYLENE AND MEET THE REQUIREMENTS OF ASTM C478. SEE TYPICAL STEP DETAIL.
7. TOTAL HEIGHT PER JOB SPECIFICATIONS.
8. PIPE PENETRATION TO BE AS PER JOB REQUIREMENTS. PIPE TO BE INSTALLED BY CONTRACTOR. SEE TYPICAL MANHOLE PIPE CONNECTION DETAIL.
9. CAST IN HATCH TO BE AS PER SPECIFICATIONS, SUPPLIED BY EITHER C.P.C. OR CUSTOMER.
10. JOINTS TO BE SEALED WITH PREFORMED BUTYL RUBBER SEALANT CONFORMING TO REQUIREMENTS OF ASTM C990. SEE TYPICAL MANHOLE SECTION JOINT DETAIL.